

A HIGH QUALITY SPRAYER THAT CAN BE DEDICATED TO THE APPLICATION OF CAL-SHIELD!

- Durable polyethylene construction.
- Funnel top for easy filling.
- Utilizes a metal striking plate to prevent premature fatigue on the pump cap.
- Built-in air pump allows good working pressure to be obtained within moments.
- Extension wand and 3 feet of hose permit reaching difficult areas.
- All-brass construction of wand, handle and nozzle

Description

The Cal-Shield Poly Sprayer is constructed of high-density polyethylene. It has a funnel top which provides for easy chemical pouring and has a one gallon working capacity. It comes with a 10" polypropylene pump, brass handle and extension wand with adjustable nozzle, a wear-resistant hose and a pressure relief valve.

Principal Uses

The Cal-Shield Poly Sprayer should be used for the dedicated spraying Cal-Shield on air conditioning cooling coils, air-cooled condensers, finned heating coils, and refrigeration case or cooler coils, that have been cleaned with Cal-Brite, Nu-Brite, Alka-Brite Plus or any other Nu-Calgon coil cleaner.

Packaging

1 each 4770-2

Operation

1. Inspect sprayer, and insure the hose is securely attached to the tank and to the shut-off handle.
2. Remove the pump from the tank by turning counter clockwise.
3. Fill tank with Cal-Shield to fill line on side of tank.

Sprayers

Cal-Shield Poly Sprayer



4. Close tank by inserting pump assembly through opening. Turn cap right (clockwise) until pump is sealed tightly into the tank (hand-tighten only).
5. Pump plunger to compress air and create pressure in tank. As pressure drops during use, recharge with more pump strokes. More strokes will be needed if the tank is not full, or as the sprayer is used and the pressure drops.
6. Set nozzle at an acceptable spray pattern, and apply Cal-Shield to coil with a gentle back and forth spraying action.
7. Upon completion of the application, use relief valve to relieve pressure and store sprayer with Cal-Shield for next application.

Relieving Pressure

Simply engage the pressure relief valve.

NOTE: Never stand with head or body over pump when operating or removing pump. If pump does not turn freely when removing, make sure there is no pressure in the tank.

Care for Sprayer

For long term storage, rinse with clean water and drain completely. Store upside down in dry place. Remove pump and hang up separately. Pump works easier and faster if you oil the pump occasionally. Squirt any clean oil through opening around pump rod.

Troubleshooting

If you cannot build up pressure:

Remove pump. Hold rubber check valve on end of pump closed and operate pump. If little or no resistance is felt on down stroke, the plunger cup or its check valve are probably at fault. Pull plunger cup to top of cylinder and squirt a little clean oil onto the cylinder wall and edge of cup. If this does not correct the problem, unscrew the pump cap from the top of the pump cylinder. Pull out plunger assembly and inspect cup for scoring, cracking, or dirt under cup check valve. To replace plunger cup, unscrew old cup and screw new cup on until top of cup just touches bump on side of rod. Check that the rod has not entered cup so far that it is pushing check valve out of cup. Inspect pump cylinder gasket and check valve for damage or dirt. Carefully insert plunger assembly into cylinder. Fit the notches of the cam plate into the notches on top of the pump cylinder, then screw the pump cap onto pump cylinder.

If shut-off leaks:

Leaks at threads can be cured by further tightening or sealing with pipe joint compound. For other leaks or failure to shut off properly, disassemble and check for dirt or damage to seals and spring.

Incorrect spray pattern:

This is almost always caused by dirt inside nozzle. After long use, nozzle cap may wear and should be replaced if necessary.

Read and understand the product's label and Material Safety Data Sheet ("MSDS") for precautionary and first aid information.

The MSDS is available on the Nu-Calgon website at www.nucalgon.com or is returnable by U.S. Mail upon request.

REPLACEMENT PARTS

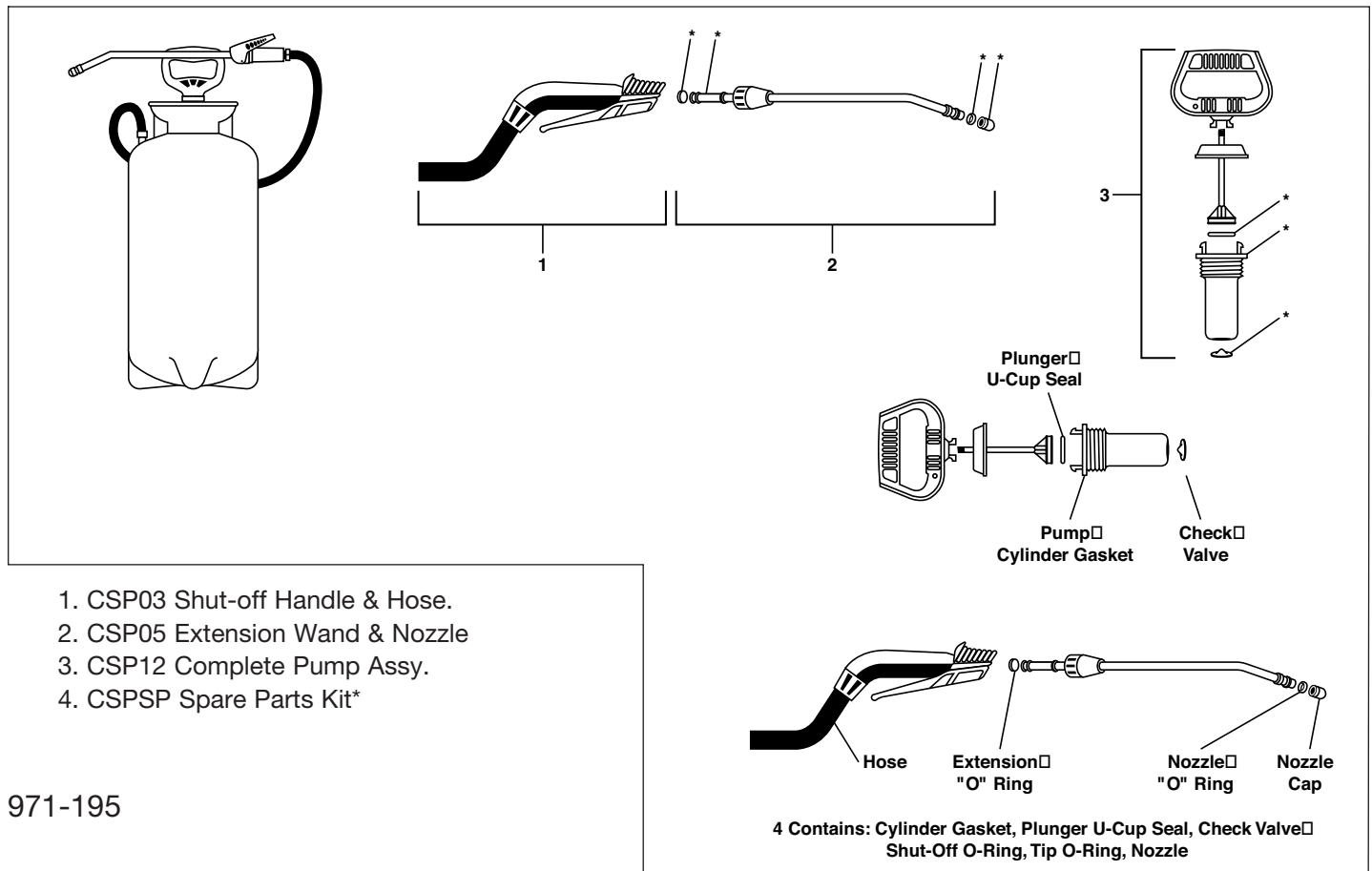

971-195